

Revision History			
REV	Description	Date	APP'D
A	3LD SOT 23 (Option 3)	Feb/18/2021	ECN 2108-03 jh

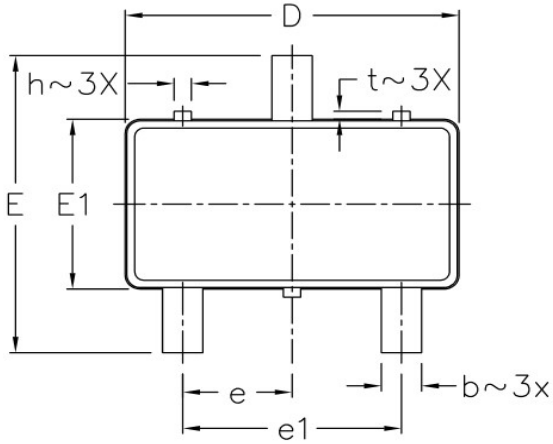

TOP VIEW

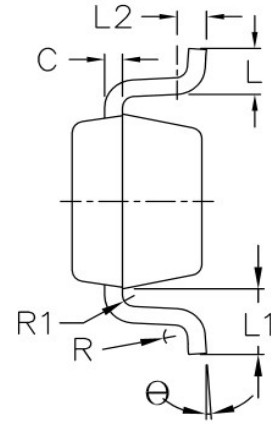

SIDE VIEW - 1

SYMBOLS	SOT-23			
	MM		INCH	
	MIN.	MAX.	MIN.	MAX.
A	—	1.45	—	0.0571
A1	0.00	0.15	0.0000	0.0059
A2	0.90	1.30	0.0354	0.0512
b	0.30	0.50	0.0118	0.0197
c	0.08	0.22	0.0031	0.0087
D	2.80	3.00	0.1102	0.1181
E	2.60	3.00	0.1024	0.1181
E1	1.50	1.70	0.0591	0.0669
e	0.87	1.03	0.0343	0.0406
e1	1.82	1.98	0.0717	0.0780
L	0.30	0.60	0.0118	0.0236
L1	0.50	0.80	0.0197	0.0315
L2	0.25 BSC		0.0098 BSC	
R	0.10	—	0.0039	—
R1	0.10	0.25	0.0039	0.0098
θ	0°	8°	0°	8°
θ1	5°	15°	5°	15°
θ2	5°	15°	5°	15°
t	—	0.15	—	0.0059
h	—	0.25	—	0.0098

TERMINAL DETAILS

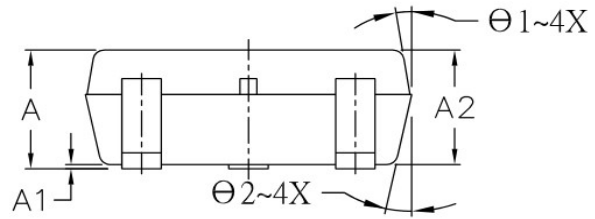

SIDE VIEW - 2

1. Refer to Jecdec MO-178
2. Dimension "D" does not include mold flash, protrusions or gate burrs.
Mold flash, protrusion or gate burrs shall not exceed 10mils per side.
3. Dimension "E1" does not include inter-lead flash or protrusions.
4. All dimensions are milimeters.

		Maxlinear Corporation	
		3LD SOT 23 (Option 3) PACKAGE OUTLINE	
Packaging Approval:		Drawing No. : POD - 00000162	
By: YG Eom	Date: Feb.18.2021	Revision: A	Sheet: 1 OF 1