

Part Number	Package   Size	Subcon   Reference Doc & Rev
Snowtown   MXL83411-ADA-R; MXL83433-ADA-R; MXL83434-ADA-R	16L SOP	Greatek   J1-0216N-001

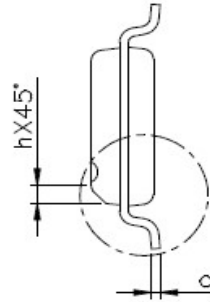

SYMBOLS	STANDARD		THERMAL	
	MIN.	MAX.	MIN.	MAX.
A	—	1.75	—	1.70
A1	0.10	0.25	0.00	0.15
A2	1.25	—	1.25	—
b	0.31	0.51	0.31	0.51
c	0.10	0.25	0.10	0.25
D	9.90 BSC		9.90 BSC	
E	6.00 BSC		6.00 BSC	
E1	3.90 BSC		3.90 BSC	
e	1.27 BSC		1.27 BSC	
L	0.40	1.27	0.40	1.27
h	0.25	0.50	0.25	0.50
θ°	0	8	0	8

UNIT : mm

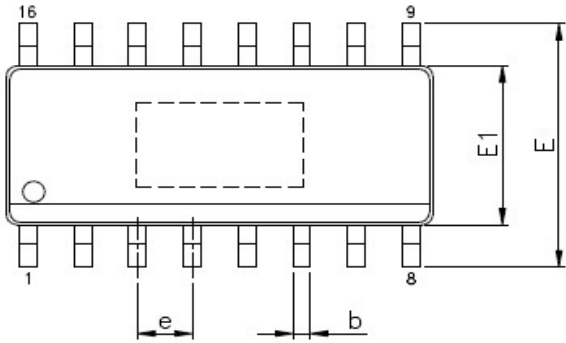
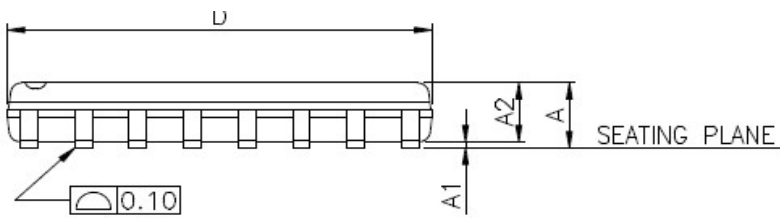

THERMALLY ENHANCED DIMENSIONS(UNIT : mm)

PAD SIZE	E2		D1	
	MIN.	MAX.	MIN.	MAX.
95*X18*	1.68	2.56	3.86	4.72



\*表示汎用字元,此汎用字元可能被其它不同字元所取代,实际的字元请参考bonding diagram所示.

\* is an universal character, which means maybe replaced by specific character, the actual character please refers to the bonding diagram.

NOTES:

- JEDEC OUTLINE : MS-012 AC REV.F (STANDARD)  
MS-012 BC REV.F (THERMAL)
- DIMENSIONS "D" DOES NOT INCLUDE MOLD FLASH, PROTRUSIONS OR GATE BURRS.MOLD FLASH, PROTRUSIONS AND GATE BURRS SHALL NOT EXCEED 0.15mm. PER SIDE.
- DIMENSIONS "E1" DOES NOT INCLUDE INTER-LEAD FLASH, OR PROTRUSIONS. INTER-LEAD FLASH AND PROTRUSIONS SHALL NOT EXCEED 0.25mm PER SIDE.

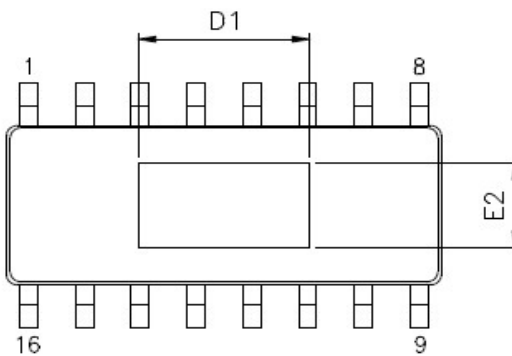

(THERMAL VARIATIONS ONLY)

